

Battery Charger Series

PowerBase

www.powerbasehk.com

PowerBase Industrial (HK) Ltd.

ROOM 1107, TOWER 1, ENTERPRISE SQUARE PHASE 1,
9 SHEUNG YUET ROAD, KOWLOON BAY, HONG KONG

Tel : (852) 2773 9909, 2773 9939

Fax : (852) 2773 9992

E-mail : info@powerbasehk.com

Specification

Input Voltage	Switching Power Adaptor AC 100~240V, 50~60Hz (UL, VDE, BS, SAA plugs)
	Car Adaptor DC, 12V
Charge Capability	2 x AA NiMH Batteries
	2 x AAA NiMH Batteries
	3.6V - 3.7V Li-ion Rechargeable Battery
	7.2V - 7.4V Li-ion Rechargeable Battery
Car Adaptor	12V / DC
	2A fuse, (Optional Accessory)
Charge Current	4.2V : 700mA
	8.4V : 700mA
	2.8V : 700mA
Termination Method	Auto Voltage Monitor
Features	<ul style="list-style-type: none"> - International Voltage 100~240V. - LCD indicator shows charging and discharging status. - Auto cut off device. - Short circuit protection. - Timer protection.

Model No.: **C-735**

3.6/7.2V Li-ion & NiMH Battery Charger

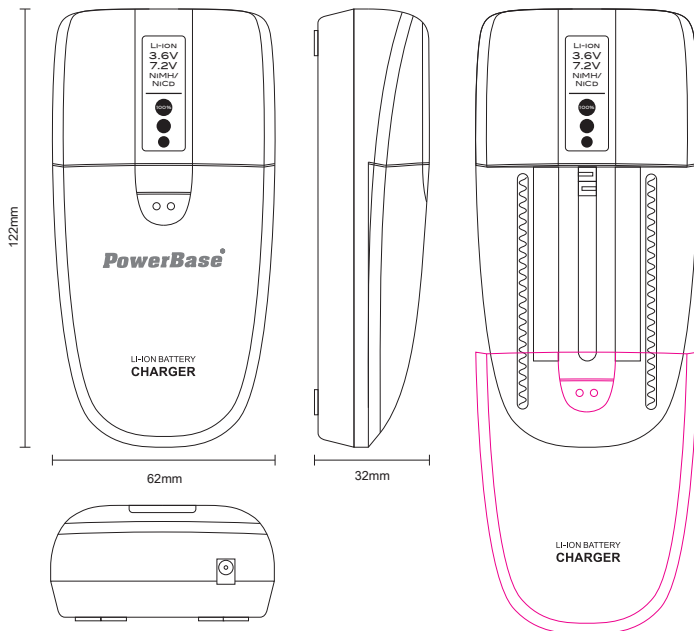

Dimension (Approximate)	123mm(L) x 61mm(W) x 32mm(H)
Weight (Approximate)	Charger : 70g (without battery)
Housing	ABS : White Colour

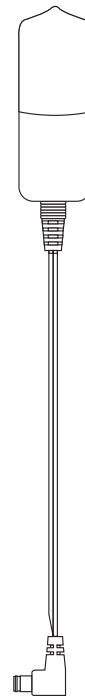

Switching Power Adaptor

UL, VDE, SAA, BS plugs
AC 100-240V

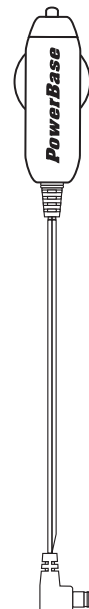

Car Adaptor

12V / DC

Individual Data sheet

This specifications is only for generally reference, about the Charger and Batteries performance, warranty, modification/designs. Please contact PowerBase for the latest information.

PowerBase