

USER MANUAL

Congratulations to your purchase of the outstanding PowerBase C-514 Multi Functional Output CHARGER. This manual will help you to understand how to operate this Charger and Batteries.

FEATURES OF C-514 RAPID CHARGER

- International Voltage 100~240V.
- 2 or 4 AA and AAA Ni-MH batteries can be charged.
- Auto Dual Channels.
- Red & Green LED Indicator.
- Automatic batteries fully charge cut-off.
- C-514 can be used in indoor by AC outlet or outdoor 12V DC Car Adaptor.
- Possess reverse polarity protection.

*C-514 Charger is designed to charge 2 or 4 AA / AAA sizes Ni-MH batteries. Please refer to the combinations below;

(1) For 2 or 4 AA / AAA size Ni-MH Cells.

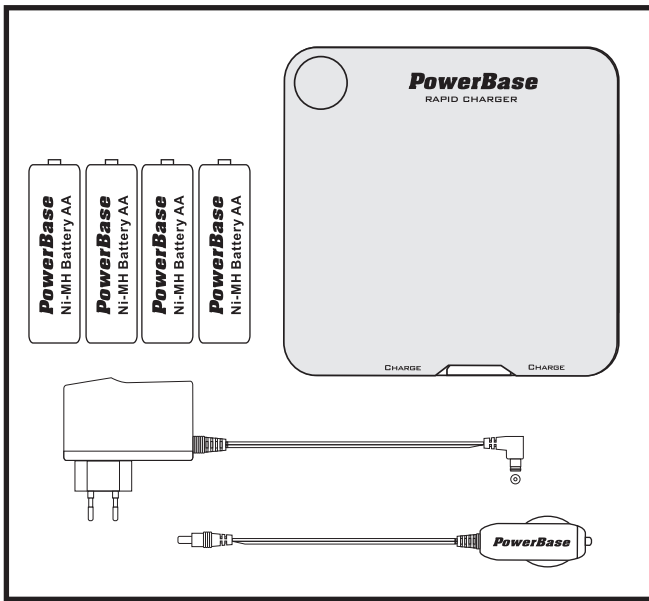

Note: Charger can only perform either " Charging " or " Output " function. It cannot perform both functions at the same time.

CAUTION

1. Open the cover when charging process is beginning. Mainly for reducing any heat generated inside the charger.
2. Do NOT recharge Ni-MH & Ni-Cd rechargeable batteries at the same time.
3. This product is designed for Ni-MH rechargeable batteries only. To avoid personal injury and damage, do not charge any primary alkaline, zinc chloride, or zinc carbon type batteries. Do not expose the charger to rain or moisture.
4. Do not operate the charger with using an extension cord.
5. Do not use the charger if it has received a sharp blow, been dropped, or damaged in anyhow
6. To reduce risk of shock, disconnect the AC power source(AC adaptor) from outlet before attempting any cleaning of the charger.
7. Do not charge a leaking, corroded or dead battery.
8. Do not attempt to repair charger by yourself. When service or repair is required, contact qualified service personnel.
9. Do not try to disassemble the charger.
10. Store the charger in a cool and dry place when not in use. Keep away from children.

PLEASE NOTE:

*PowerBase Industrial (HK) Ltd. will not be responsible for any personnel loss and/or injury if the defect was caused by misuse or mishandling by the user in any way.

CHARGING OPERATION

1. Switch the button to "Charger" position. Connect DC12V power outlet to :

- AC power adaptor

- Car adaptor

Switch the button to the "CHARGER" mode when charging. The Green LED light will stay on to indicate the charger in standby state.

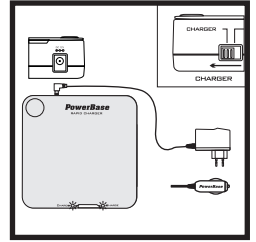

2. Select the type of batteries to be charged - AA or AAA size. Place 2/4 pieces AA or AAA size batteries for charging process.

* Open the cover during charging. It helps to reduce the high temperature created during the charging process.

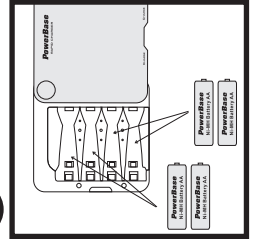

! Keep the cover open when charging

3. Indications of RED and GREEN LED Light.

Red LED Light - will turn on to indicate the charger is charging the batteries.

Green LED Light - will stay on when the charger is in standby stage, without battery. - will also turn on when the batteries are fully charged.

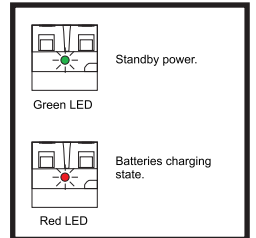

* When batteries are fully charged, remove the AC adaptor/ car adaptor from the charger and prepare for the output process.

Battery Charge Time :

Chemistry & Size	Battery Capacity	*Charging Time (Approximate)
Ni-MH AA	2500 mAh	3 hours
Ni-MH AA	2300 mAh	2.5 hours
Ni-MH AAA	1000 mAh	1.2 hours

* The charging time is only for general reference. For detail of different charging time require, please see the PowerBase battery specification and contact PowerBase for the latest information.

CHARGER C-514 SPECIFICATION :

International Voltage	Switching : 100~240V 50~60Hz 12V DC Car Adaptor
Battery Type / Size	Ni-MH AA & AAA Batteries
Charging Current	800mA x 2 or 4 AA 800mA x 2 or 4 AAA
Output Power (USB plug)	5V-5.4V , 500mA For iPhone & iPod series, mobile phones, game players (PSP/NDS)
Trickle Charge	Trickle current
Termination Method	Minus Delta V (-ΔV)
Operation Temperature	-10°C ~ 40°C

OUTPUT FUNCTION

Output Features of POWERBASE C-514 Multi functional Charger.

- Portable Emergency power back up for peripheral Equipment.
- USB Output for various devices.
- **Suitable for equipment :**
 - iPhone & iPod series
 - Mobile Phones (Nokia, Motorola, Sony Ericsson etc)
 - MP3 / MP4 Player
 - Game Players (PSP, NDS)
- With one output channel (USB plug).
- 4 pcs of AA / AAA Ni-MH batteries are required for any output function through the C-514 output channel.
- Small in size and easy to carry and use.
- After the AA / AAA batteries are fully charged, can also remove the batteries from the C-514 and place for other application.
- Continuously output supply : More than one equipment unit can acquire power from C-514
- Alternative Power source for emergency use:
If the fully charged AA/AAA batteries in C-514 have consumed most of its remaining capacity, and min. recharge time would not be allowed at that moment, 4 pcs of **Alkaline** batteries can be placed inside. The C-514 in order to provide output power to various units.

(1) Output function with accessories.

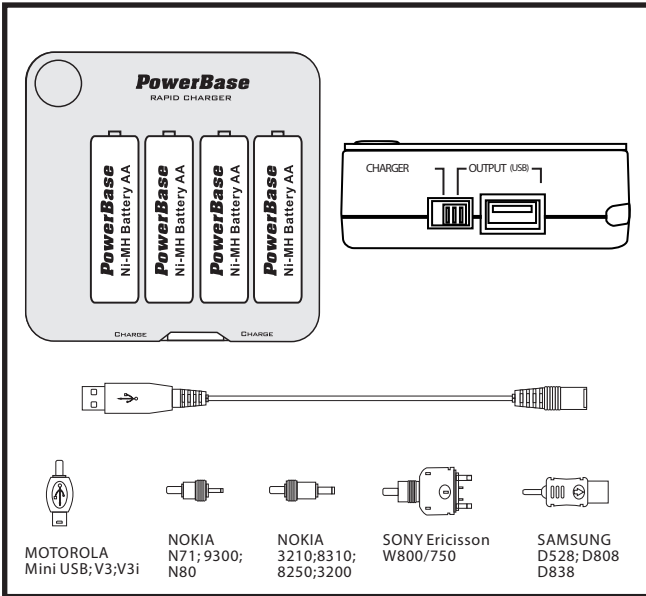

Note: Never put Ni-MH and Ni-Cd batteries together in the POWERBASE C-514 Multi Function Output Charger.

CAUTION

1. For best result of Output, please make sure the batteries in the charger are fully charged.
2. Do not put difference types of battery (Ni-Cd/ Alkaline/ Ni-MH in difference capacity) mixed together during the stage of Charging / Output.
3. When not using the charger or batteries, please take out the batteries from the charger.

OUTPUT PROCESS PROCEDURES

- 1 : Place 4 pieces of **Fully Charged** AA/AAA batteries into the C-514 charger. Switch the button to **Output** position, LED red light will turn on , show that the **Output** function is ready to start.

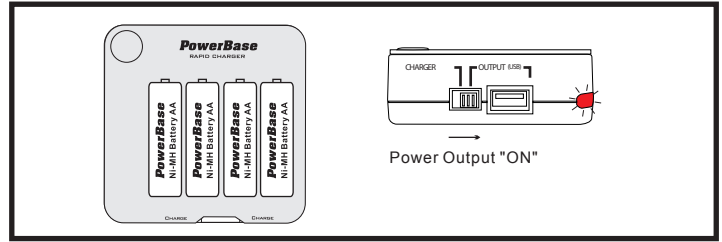

2 : Output Function (1)

- Connect the USB cable into "Output" position & plug to iPod or iPhone series. The charging process will start automatically.

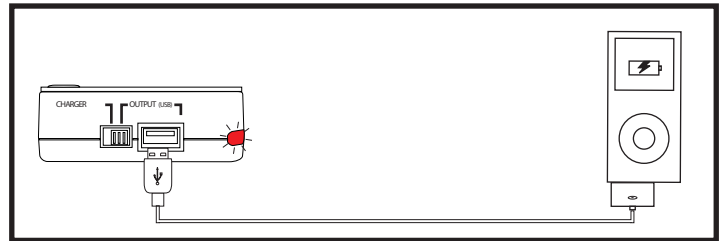

3 : Output Function (2)

- Connect the USB cable into "Output" position with the selected suitable plug to various devices such as mobile phone, game players or mp3/mp4 player. The charging will start automatically.

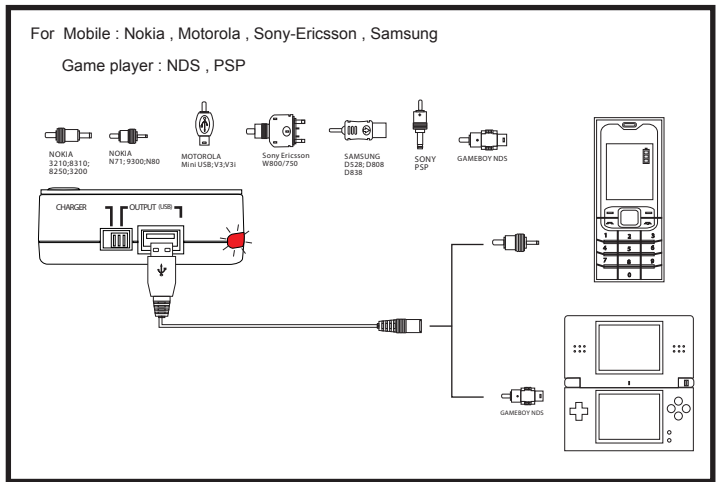

- 4) After fully charged the selected devices, unplug the cables and switch the button back to the **"Charger"** position. RED LED light will turn off immediately and the output process will be stopped. For safety reason, please take off the batteries from the C-514 charger after used.

